

Bettis D-Series

Technical data pneumatic Rack and Pinion actuators



Data sheet

Sheet No.: DPI 1.01 Rev. B
Date: November 2015

D-Series

Technical details

Standard actuator

Specifications

Pressure range:

Double acting	3 to 120 psig	0.2 - 8 barg
Spring return	43 to 120 psig	3 - 8 barg

Torque range:

130 to 14874 lbf.in at 80 psig supply pressure.
14.6 to 4955 Nm at 6 barg supply pressure.

See torque datasheets:

- * DPI 3.01 (Double Acting)
- * DPI 3.02 (Spring Return)

Operating media:

* Air, dry or lubricated and inert gasses. Air, dry or lubricated and inert gasses. Dew point 10 K below operating temperature. For temperatures below 32°F (0°C) take appropriate measures to prevent freezing of condensate.

Basic Temperature ranges:

Standard:	-4°F to 176°F	-20° to +80°C
Optional high:	-4°F to 248°F	-20° to +120°C
Optional low:	-40°F to 176°F	-40° to +80°C

(see data sheet DPI 5.02 or DPI 5.03 for high or low temperature applications)

Lubrication :

Factory lubricated for the normal life of the actuator.

Construction:

Suitable for indoor and outdoor installation.

Finish:

Polyester non-TGIC based powder coating (see data sheet DPI 6.01)

Rotation:

- * 90° Nominal
- * Double acting : Standard counter clockwise with port "A" pressurized (mode A, see data sheet DPI 7.01 for other assembly codes).
- * Spring return : Clockwise fail action (mode A, see data sheet DPI 7.02 for other assembly codes).

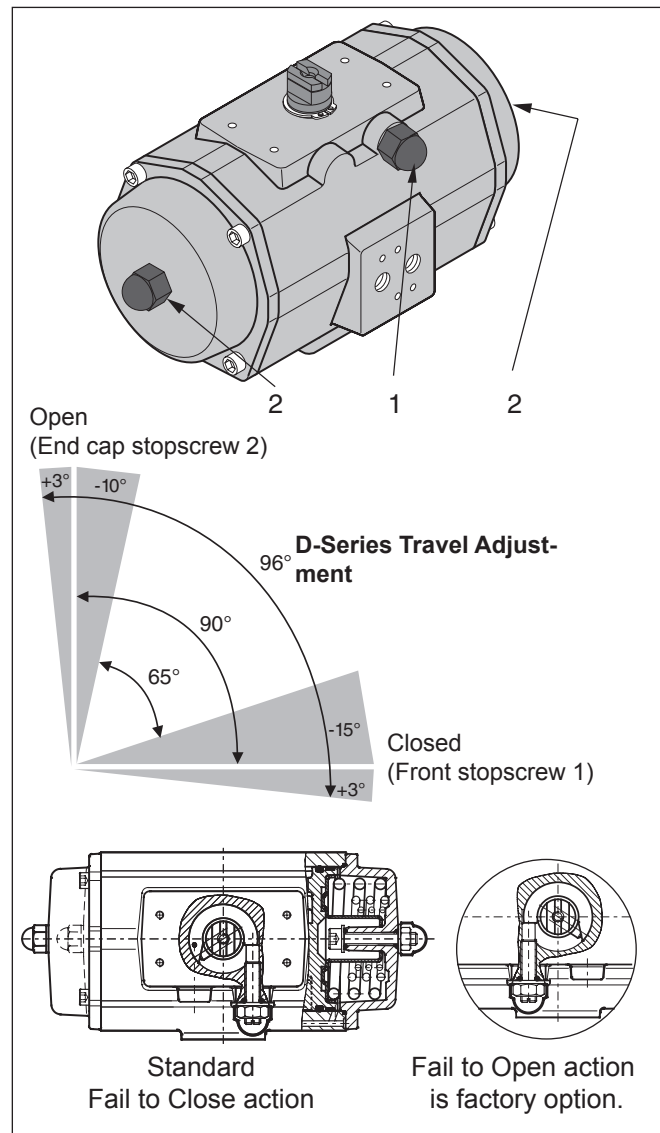

BETTIS™

www.Bettis.com

Copyright © Emerson Process Management. The information in this document is subject to change without notice.
Updated data sheets can be obtained from our website www.bettis.com or from your nearest Valve Automation Center.
USA: +1 281 477 4100 Europe: +31 74 256 1010 Asia-Pacific: +65 6501 4600

EMERSON™
Process Management

Data sheet

Sheet No.: DPI 1.02 Rev. A
Date: April 2010

D-Series

Technical data:

Actuator type		D12	D25	D40	D65	D100	D150	D200	D350	D600	D950	D1600
Bore	mm.	46	56	70	80	91	103	110	145	175	200	230
Stroke	mm.	12.6	15.7	18.8	22	25.1	31.4	37.7	37.7	44	50.3	62.8
Weight:	Double acting	kg.	0.6	1.3	1.8	2.4	3.1		5.8	10.4	19.4	42.7
	Spring return	kg.	0.7	1.7	2.4	3.6	4.6		9.1	16.9	27.6	65.8
Operating time ⁽¹⁾	sec.	0.4	0.5	0.7	1.1	1.2	1.8	2.3	3.6	4.5	5.4	6.9
Air consumption ⁽²⁾ at 1 atm (litres)	port A	stroke	0.1	0.1	0.2	0.3	0.4	0.84	0.8	1.8	2.9	4.7
	port B	stroke	0.1	0.1	0.2	0.4	0.5	0.78	1	1.9	3.1	4.9

Note:

1. Operating time is average with actuator under load and solenoid valve fitted.
2. Air consumption is the actual free air volume at 1 atm.
3. Pressure is in barg.
4. DD = Double acting
DS = Single acting (Spring Return)

Operating principle

Double acting actuator

- If port "A" is pressurised and port "B" is vented, both the pistons move outwards to the endpositions.
- The moving pistons cause the pinion to rotate counter clock wise.

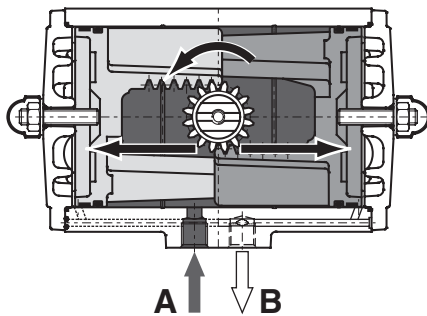

- If port "B" is pressurised and port "A" is vented, both the pistons move inwards to their block positions.
- The moving pistons cause the pinion to rotate clock wise.

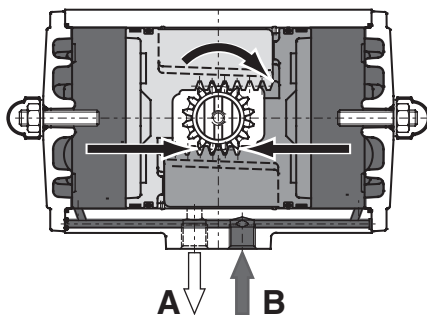

Note:

The above described operating principle is applicable for standard actuators (assembly mode A). For reverse acting actuators (assembly mode D), pressurizing the ports will result in a opposite rotation.

Single acting (spring return) actuator

- If port "A" is pressurised and port "B" is vented, both the pistons move outwards compressing the springs.
- The moving pistons cause the pinion to rotate counter clock wise.

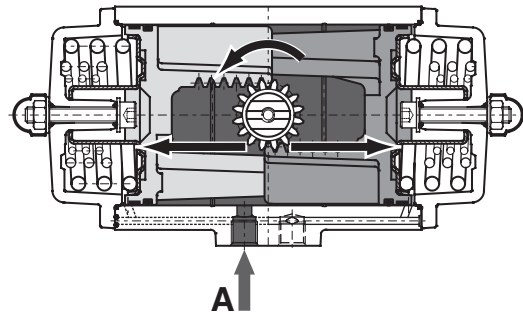

- If port "A" is vented, the spring force applied to the pistons move them inwards to their block positions.
- The moving pistons cause the pinion to rotate clock wise.

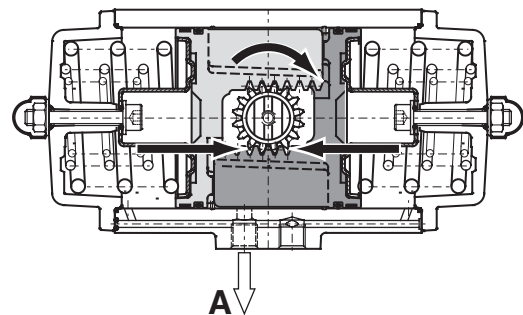

Note:

The above described operating principle is applicable for standard "Fail to Close" actuators (assembly mode A). For reverse acting "Fail to Open" actuators (assembly mode D), pressurizing the ports will result in a opposite rotation.

BETTIS™

www.Bettis.com

Copyright © Emerson Process Management. The information in this document is subject to change without notice. Updated data sheets can be obtained from our website www.bettis.com or from your nearest Valve Automation Center.
USA: +1 281 477 4100 Europe: +31 74 256 1010 Asia-Pacific: +65 6501 4600

EMERSON™
Process Management

Data sheet

Sheet No.: DPI 2.01 Rev. B
Date: August 2010

D-Series

Pneumatic Actuator Configuration

DS0040 . B 2 A 04 K . 14 K 0

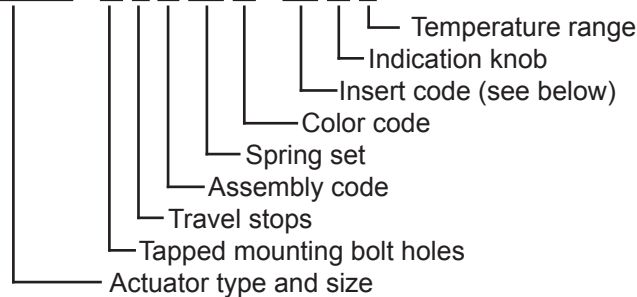

Actuator Size and Type

DD D-Series & Double-Acting or
DS D-Series & Spring-Return
XXXX Body size (0012, 0025, 0040, 0065, 0100,
0150, 0200, 0350, 0600, 0950 or 1600)

Tapped, Mounting Bolt Holes

B UNC (Standard Bettis Trim, ISO 5211 with
UNC bolt holes on valve mounting side, Metric
bolt holes on NAMUR patterns NPT ports)
see data sheet DPI 4.01 or DPI 4.02

Travel Stops

2 Dual Travel Stops (Standard Bettis Trim for all
models except for 0012)
0 No Travel Adjustment (Only for model 0012)

Assembly Modes

A Standard Bettis Trim Fail-CW (Mounted in line,
standard)
B Fail-CW (mounted across line, special order)
C Fail CCW (mounted across line, special order)
D Fail CCW (mounted in line, special order)
see data sheet DPI 7.01 or DPI 7.02

Spring Set Number

00 No springs (Double-Acting)
01, 02, Spring set (Spring-Return only)
03, 04,
05 or 06
see data sheet DPI 3.02 or DPI 8.01

Color Code

K Bettis orange

Insert Code – Inner Square

XX Bettis standard will be the ISO size,
see data sheet DPI 4.03

Indication Knob

D Visual Indication (Disk, use only when required
with switch for visual indication)
K Visual Indication (Knob, Standard)
N No Visual Indicator

Temperature Range

0 Standard Temperature -4°F to +175°F
(-20°C to 80°C), *see data sheet DPI 5.01*
1 High Temperature -4°F to 250°F
(-20°C to 121°C), *see data sheet DPI 5.03*
2 Low Temperature -40°F to 175°F
(-40°C to 80°C), *see data sheet DPI 5.02*

Note:

For temperatures outside these ranges contact Bettis

BETTIS[™]

www.Bettis.com

Copyright © Emerson Process Management. The information in this document is subject to change without notice.
Updated data sheets can be obtained from our website www.bettis.com or from your nearest Valve Automation Center.
USA: +1 281 477 4100 Europe: +31 74 256 1010 Asia-Pacific: +65 6501 4600

EMERSON[™]
Process Management

Data sheet

Sheet No.: DPI 3.01 Rev. B
Date: November 2015

D-Series

Torque (lbf.in)

DD - Double acting actuators

Actuator	Torque of double acting actuators (in lbf.in)													
	Type	Size	Supply pressure (psi)											
		30	35	40	45	50	55	60	70	75	80	90	100	120
DD	12	43.9	51.4	58.9	66.4	73.9	81.4	88.9	104	111	119	134	149	179
DD	25	81.4	95.3	109	123	137	151	165	193	206	220	248	276	332
DD	40	153	179	205	231	257	283	309	361	387	413	466	518	622
DD	65	233	272	312	352	392	431	471	551	590	630	709	789	948
DD	100	344	402	461	520	578	637	696	813	872	930	1048	1165	1400
DD	150	551	645	739	833	927	1021	1115	1303	1397	1491	1680	1868	2244
DD	200	754	883	1011	1140	1269	1398	1527	1784	1913	2042	2299	2557	3072
DD	350	1310	1534	1757	1981	2205	2428	2652	3100	3323	3547	3994	4442	5337
DD	600	2226	2606	2986	3366	3747	4127	4507	5267	5647	6028	6788	7548	9069
DD	950	3323	3890	4458	5025	5593	6160	6728	7862	8430	8997	10132	11267	13537
DD	1600	5493	6431	7369	8307	9245	10183	11121	12998	13936	14874	16750	18626	22379

Note:

- Emerson Process Management recommends that the valve manufacturer supply the maximum required torque values (Including any adjustments or suggested safety factors for valve service conditions or application). Additionally, the valve manufacturer must identify at which position(s) and direction(s) of rotation (Counter Clock Wise or Clock Wise) these maximum requirements occur.
- If in doubt, or you require any assistance with sizing actuators, do not hesitate to contact your nearest Emerson's Valve Automation representative.

Double Acting Torque

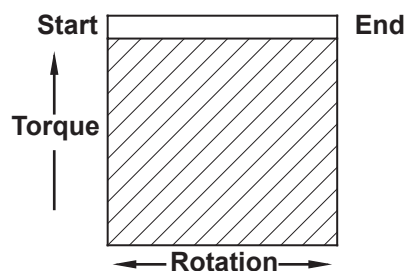

BETTIS™

www.Bettis.com

Copyright © Emerson Process Management. The information in this document is subject to change without notice.
Updated data sheets can be obtained from our website www.bettis.com or from your nearest Valve Automation Center.
USA: +1 281 477 4100 Europe: +31 74 256 1010 Asia-Pacific: +65 6501 4600

EMERSON™
Process Management

Data sheet

Sheet No.: DPI 3.02 Rev. C

Date: November 2015

D-Series

Torque (lbf.in)

DS - Single acting actuators (Spring Return)

Springset	nr	Air Stroke (lbf.in)										Spring Stroke	
		SUPPLY PRESSURE (in PSI)										(lbf.in)	
		40		60		80		100		120			
Actuator Type	C	D	C	D	C	D	C	D	C	D	E	F	
DS 12	2	-	-	48	24	80	55	111	87	143	119	63	40
DS 25	2	71	44	130	103	189	162	248	221	306	280	62	39
	3	48	8	107	67	166	126	225	185	284	244	94	59
	4	-	-	85	31	144	90	203	149	262	208	125	78
	5	-	-	-	-	121	54	180	113	239	172	156	98
	6	-	-	-	-	-	-	158	77	217	136	188	117
DS 40	2	133	82	243	193	354	303	464	414	575	524	117	73
	3	91	15	201	125	312	236	422	346	533	457	176	110
	4	-	-	159	58	270	169	380	279	491	390	234	146
	5	-	-	-	-	228	101	338	212	449	322	293	183
	6	-	-	-	-	-	-	296	144	406	255	351	220
DS 65	2	196	117	365	285	533	454	701	622	870	790	186	117
	3	-	-	297	178	466	347	634	515	802	683	279	176
	4	-	-	230	71	398	240	567	408	735	576	372	234
	5	-	-	-	-	331	133	500	301	668	470	465	292
	6	-	-	-	-	-	-	432	194	601	363	558	351
DS 100	2	303	192	552	441	801	690	1050	939	1299	1188	258	161
	3	211	44	460	293	709	542	958	791	1206	1039	387	242
	4	-	-	367	144	616	393	865	642	1114	891	516	323
	5	-	-	-	-	523	245	772	494	1021	743	646	403
	6	-	-	-	-	430	96	679	345	928	594	775	484
DS 150	2	486	297	884	696	1283	1094	1681	1493	2080	1892	423	259
	3	337	54	735	453	1134	852	1533	1250	1931	1649	634	388
	4	-	-	587	210	985	609	1384	1007	1783	1406	845	517
	5	-	-	-	-	837	366	1235	764	1634	1163	1056	647
	6	-	-	-	-	-	-	1087	522	1485	920	1268	776
DS 200	2	656	406	1202	952	1747	1498	2293	2043	2838	2589	579	362
	3	448	74	994	619	1539	1165	2085	1710	2631	2256	868	542
	4	-	-	786	287	1332	832	1877	1378	2423	1924	1158	723
	5	-	-	-	-	1124	500	1669	1045	2215	1591	1447	904
	6	-	-	-	-	-	-	1462	713	2007	1258	1736	1085
DS 350	2	1105	684	2053	1632	3001	2580	3949	3528	4897	4476	1025	658
	3	-	-	1675	1043	2623	1991	3571	2939	4519	3887	1537	987
	4	-	-	1297	455	2245	1403	3193	2351	4141	3299	2049	1317
	5	-	-	-	-	1866	814	2814	1762	3762	2710	2561	1646
	6	-	-	-	-	-	-	2436	1173	3384	2121	3074	1975
DS 600	2	1920	1183	3531	2794	5142	4405	6753	6016	8364	7628	1723	1082
	3	-	-	2909	1804	4520	3415	6131	5026	7742	6637	2585	1624
	4	-	-	2287	814	3898	2425	5509	4036	7120	5647	3446	2165
	5	-	-	-	-	3276	1434	4887	3046	6498	4657	4308	2706
	6	-	-	-	-	-	-	4265	2055	5876	3666	5169	3247
DS 950	2	2898	1777	5303	4182	7708	6587	10113	8992	12518	11397	2563	1587
	3	-	-	4391	2709	6796	5114	9201	7519	11606	9924	3844	2381
	4	-	-	3479	1236	5884	3641	8288	6046	10693	8451	5125	3175
	5	-	-	-	-	4971	2168	7376	4573	9781	6978	6407	3968
	6	-	-	-	-	-	-	6464	3100	8869	5505	7688	4762
DS 1600	2	4765	2988	8741	6964	12716	10939	16692	14915	20668	18890	4193	2646
	3	3244	578	7220	4554	11196	8530	15171	12505	19147	16481	6289	3970
	4	-	-	5699	2145	9675	6120	13650	10096	17626	14071	8385	5293
	5	-	-	-	-	8154	3711	12129	7686	16105	11662	10481	6616
	6	-	-	-	-	-	-	10608	5277	14584	9252	12578	7939

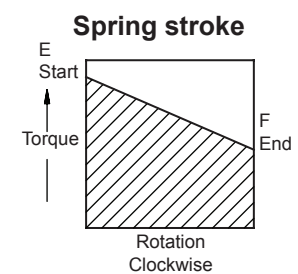
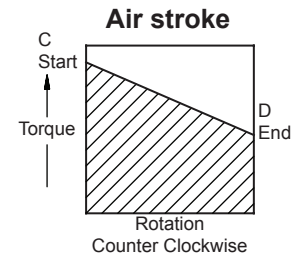

Notes:

- Emerson Process Management - Valve Automation recommends that the valve manufacturer supply the maximum required torque values (Including any adjustments or suggested safety factors for valve service conditions or application). Additionally, the valve manufacturer must identify at which position(s) and direction(s) of rotation (Counter Clock Wise or Clock Wise) these maximum requirements occur.
- If in doubt, or you require any assistance with sizing actuators, do not hesitate to contact your nearest Emerson's Valve Automation representative.

BETTIS™

www.Bettis.com

Copyright © Emerson Process Management. The information in this document is subject to change without notice.

Updated data sheets can be obtained from our website www.bettis.com or from your nearest Valve Automation Center.

USA: +1 281 477 4100 Europe: +31 74 256 1010 Asia-Pacific: +65 6501 4600

Data sheet

Sheet No.: DPI 4.01 Rev. B
Date: November 2015

D-Series

Dimensions and Torque

DD/DS12

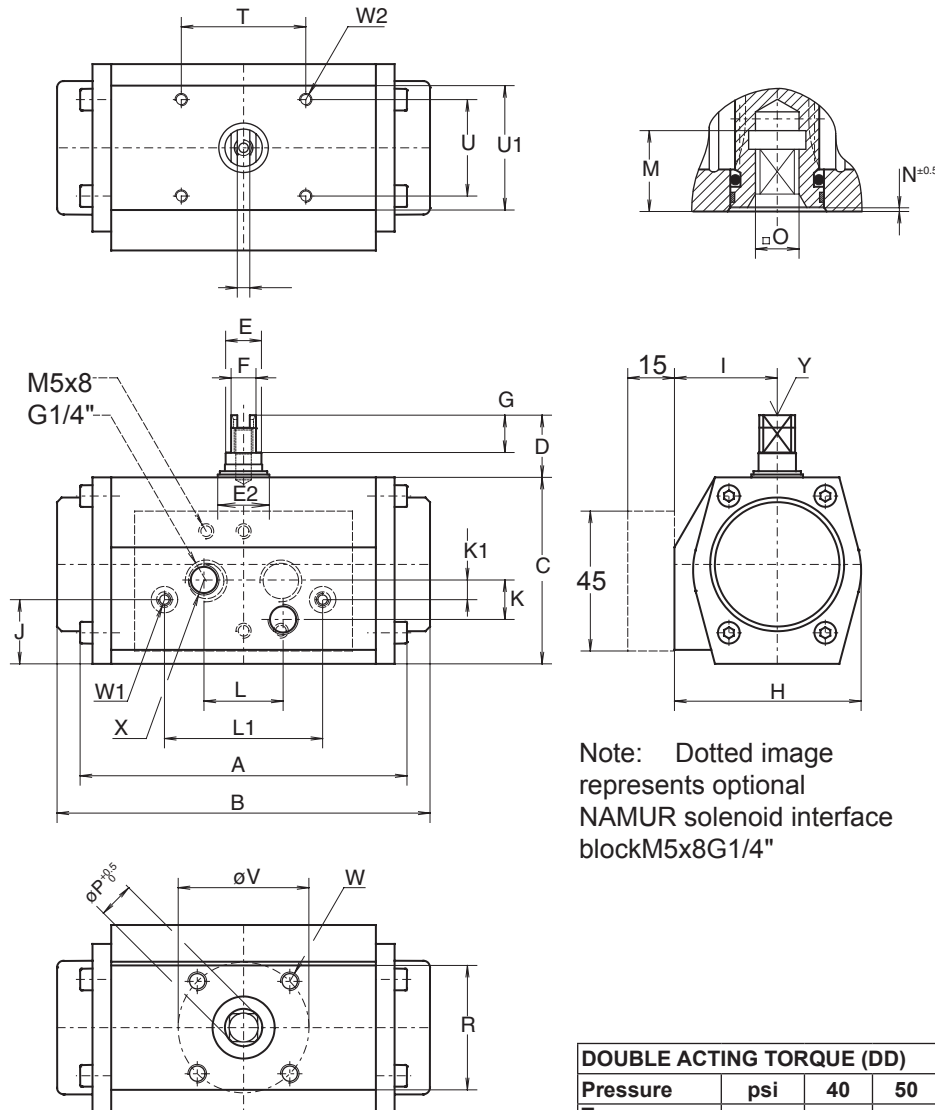

Dim. in Inches	
A DD	4.06
B DS	4.65
C	2.36
D	0.79
E	0.63
E2	0.91
F	0.39
G	0.47
H	2.36
I	1.30
J	0.83
K	0.50
K1	0.25
L	1.00
L1	2.00
M	0.65
N	0.039
Omax.	0.358
Omin.	0.354
P	0.476
R	1.57
R1	1.57
T	1.57
U	1.22
V	1.654
W	10-24 UNCx.24"
W1	10-24 UNCx.24"
W2	10-24 UNCx.24"
X	1/8"NPT
Y	M6x.48

Note: Dotted image represents optional NAMUR solenoid interface block M5x8G1/4"

DOUBLE ACTING TORQUE (DD)									
Pressure	psi	40	50	60	70	80	90	100	120
Torque 90°/180°	(lbf.in)	59	74	89	104	119	134	149	179
SINGLE ACTING TORQUE (DS)									
Pressure	psi	Air stroke						Spring stroke	
		60		80		100		start	end
Position	-	start	end	start	end	start	end	start	end
Torque 90°	(lbf.in)	48	23	80	55	112	87	64	41
Torque 180°	(lbf.in)	49	25	81	57	112	88	63	40

BETTIS™

www.Bettis.com

Copyright © Emerson Process Management. The information in this document is subject to change without notice. Updated data sheets can be obtained from our website www.bettis.com or from your nearest Valve Automation Center. USA: +1 281 477 4100 Europe: +31 74 256 1010 Asia-Pacific: +65 6501 4600



EMERSON™

Process Management

Data sheet

Sheet No.: DPI 4.02 Rev. B

Date: June 2013

D-Series

Dimensions

DD & DS - Actuators

Dim. in inch	D-Series actuators									
	D 25	D 40	D 65	D100	D150	D200	D 350	D600	D950	D1600
A = DD	6.26	7.09	7.83	8.70	10.00	11.14	12.01	15.24	16.69	20.31
B = DS	6.77	8.03	9.80	10.51	12.20	14.17	15.24	18.78	20.35	25.08
C	3.15	3.66	4.13	4.65	5.51	5.63	7.13	8.66	10.20	11.69
D	0.79	0.79	0.79	0.79	0.79	0.79	0.79	1.18	1.18	1.18
E	0.63	0.87	0.87	0.87	1.42	1.42	1.42	2.17	2.17	2.52
E2	0.91	1.18	1.18	1.18	1.77	1.77	1.77	2.56	2.56	2.95
F	0.39	0.55	0.55	0.55	0.75	0.75	0.75	1.42	1.42	1.42
G	0.47	0.47	0.47	0.47	0.47	0.47	0.47	0.39	0.39	0.39
H	2.91	3.39	3.86	4.25	4.76	5.04	6.81	8.15	9.09	10.43
I	1.81	2.09	2.26	2.48	2.76	2.87	3.71	4.45	4.96	5.59
J	1.26	1.32	1.54	1.59	1.59	1.99	2.85	3.33	4.15	4.74
J1	1.11	1.38	1.57	1.72	1.92	2.12	2.85	3.50	4.03	4.50
K	0.94	1.30	1.30	1.50	2.17	2.17	2.17	2.68	2.95	3.74
L	0.45	0.61	0.61	0.73	0.97	0.97	0.97	1.63	1.63	1.87
M1	1.36	1.36	1.36	1.36	1.97	1.97	1.97	2.05	2.52	3.23
M2	-	-	-	1.06	-	1.46	1.46	-	-	-
M3	0.669	0.669	0.669	0.787	0.787	1.161	1.161	1.161	1.949	2.303
N	0.04	0.04	0.04	0.06	0.04	0.06	0.06	0.06	0.06	0.06
O max.	0.436	0.554	0.554	0.751	0.751	0.870	1.067	1.067	1.424	1.817
O min.	0.433	0.551	0.551	0.748	0.748	0.866	1.063	1.063	1.417	1.811
P	0.555	0.713	0.713	0.992	1.004	1.110	1.425	1.425	1.898	2.370
P1	0.555	0.713	0.831	0.909	1.122	1.303	1.303	1.437	1.909	2.382
P2	-	-	-	0.988	0.988	1.264	1.264	-	-	-
R	2.05	2.56	2.76	2.76	3.46	3.54	4.49	4.88	5.12	6.06
R1	1.97	1.97	1.97	2.36	2.36	2.36	2.36	3.54	3.54	4.92
R2	-	-	-	-	-	-	-	-	-	5.20
S	2.05	2.56	2.76	2.76	3.62	3.54	4.49	4.88	5.59	11.02
S1	3.94	3.94	3.94	3.94	3.94	3.94	3.94	6.69	6.69	8.27
T1	3.150	3.150	3.150	3.150	3.150	3.150	3.150	5.118	5.118	5.118
U1	1.181	1.181	1.181	1.181	1.181	1.181	1.181	1.181	1.181	1.181
	F03	F05	F05	F05	F07	F07	F07	F10	F10	F16
V	1.417	1.969	1.969	1.969	2.756	2.756	2.756	4.016	4.016	6.496
W	10-24 x.31	1/4"- 20 x.39	1/4"- 20 x.39	1/4"- 20 x.39	5/16"- 18 x.39	5/16"- 18 x.39	5/16"- 18 x.39	3/8"- 16 x.63	3/8"- 16 x.63	3/4"-10 x1.14
	F05	F07	F07	F07	F10	F10	F10	F12	F14	-
V1	1.969	2.756	2.756	2.756	4.016	4.016	4.016	4.921	5.512	-
W1	1/4"- 20 x.39	5/16"- 18 x.39	5/16"- 18 x.39	5/16"- 18 x.39	3/8"- 16 x.63	3/8"- 16 x.63	3/8"- 16 x.63	1/2"- 13 x.79	5/8"- 11 x.98	-
X	1.42	1.63	1.63	1.99	2.36	2.46	2.85	4.02	4.02	4.31
X max.	1.63	1.91	1.91	2.30	2.64	2.91	3.31	4.51	4.51	4.88
Y	1/4"- 20	5/16"- 18	5/16"- 19	3/8"- 16	3/8"- 16	1/2"- 13	1/2"- 13	5/8"- 11	5/8"- 11	3/4"-10

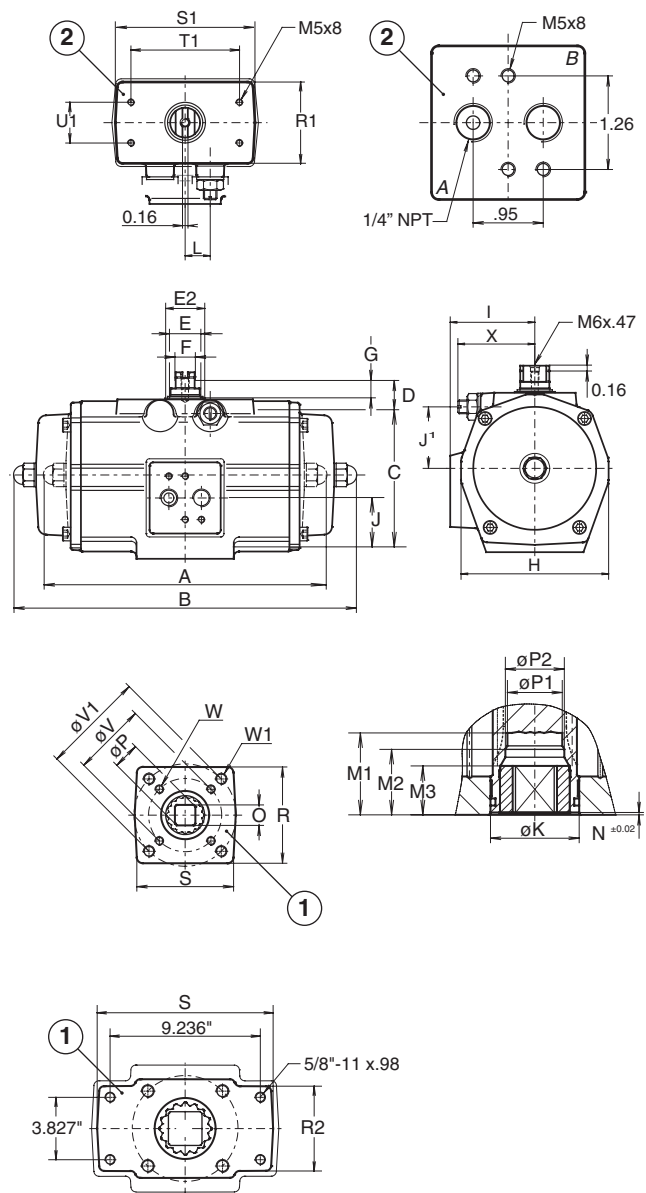

Note:

1. Flange and square drive to ISO 5211
2. Top and solenoid flange to VDE/VDI 3845 (NAMUR)

BETTIS™

www.Bettis.com

Copyright © Emerson Process Management. The information in this document is subject to change without notice.

Updated data sheets can be obtained from our website www.bettis.com or from your nearest Valve Automation Center.

USA: +1 281 477 4100 Europe: +31 74 256 1010 Asia-Pacific: +65 6501 4600



EMERSON™

Process Management

Data sheet

Sheet No.: DPI 4.03 Rev. A
Date: April 2010

D-Series

Drive inserts

Description

Most of the Bettis D-Series actuators are fitted with drive inserts. This enables actuators to be directly mounted onto suitable valves and eliminates the need for a bracket and coupling type mounting kit. The use of direct mounts significantly cuts the cost of the valve/actuator assembly.

Standard actuators are fitted with square drive inserts in accordance with ISO 5211 (or DIN 3337), but a wide variety of other inserts are also available. Special inserts may have oversize or undersize squares, double-D and shaft key way forms.

Drive inserts can be supplied on factory built actuators or as loose items and are easily replaceable at distributor or end user level.

Where direct mounts are not possible, for instance on valves with exposed gland packing, the use of inserts often simplifies the design of the mounting kit.

Material: Aluminum alloy
Finish : Anodized

The 0012 actuator size does not have inserts, but has the inner square directly in the bottom of the pinion. See the following data sheet DPI 4.01 for more information.

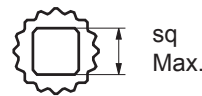
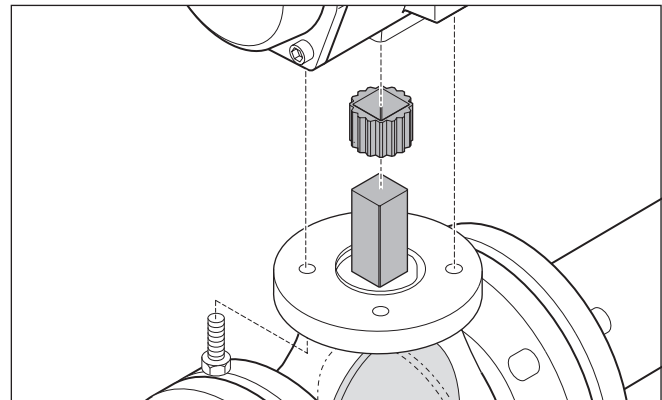

Standard inserts

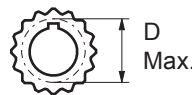
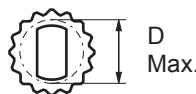

Optional inserts

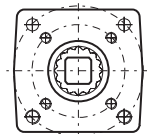
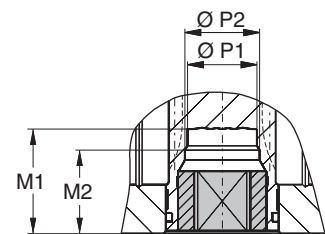

Insert mounting acc. ISO 5211

Inserts with inner-square-dimensions per actuator type																		
	D25		D40 / D65		D100		D150		D200		D350		D600		D950		D1600	
	mm.	inch	mm.	inch	mm.	inch	mm.	inch	mm.	inch	mm.	inch	mm.	inch	mm.	inch	mm.	inch
Standard inserts dimensions																		
ISO5211	11	0.433	14	0.551	19	0.748	19	0.748	22	0.866	27	1.063	27	1.063	36	1.417	46	1.811
Optional insert dimensions																		
	9	0.354	10	0.394	12	0.472	14	0.551	14	0.551	14	0.551	14	0.551	22	0.866	-	-
	10	0.394	12	0.472	14	0.551	16	0.630	16	0.630	16	0.630	16	0.630	-	-	-	-
	-	-	-	-	16	0.630	22	0.866	17	0.669	17	0.669	17	0.669	-	-	-	-
	-	-	-	-	-	-	24	0.945	19	0.748	19	0.748	19	0.748	-	-	-	-
	-	-	-	-	-	-	27	1.063	24	0.945	24	0.945	24	0.945	-	-	-	-
Maximum insert dimensions																		
M1	34.5	1.36	34.5	1.36	34.5	1.36	50	1.97	50	1.97	50	1.97	52	2.05	64	2.52	82	3.23
M2	-	-	-	-	27	1.06	37	1.46	37	1.46	37	1.46	-	-	-	-	-	-
P1	14.1	0.56	18.1	0.71	23.1	0.91	28.5	1.12	32.1	1.26	32.1	1.26	36.5	1.44	48.5	1.91	60.5	2.38
P2	-	-	-	-	25.2	0.99	36.2	1.43	36.2	1.43	36.2	1.43	-	-	-	-	-	-
Sq max.	11	0.433	16	0.630	19	0.748	27	1.063	27	1.063	27	1.063	27	1.063	36	1.417	46	1.811
D max.	13.8	0.543	21	0.827	23.6	0.929	36.6	1.441	33.6	1.323	33.6	1.323	33.6	1.323	45	1.772	60	2.362



www.Bettis.com

Copyright © Emerson Process Management. The information in this document is subject to change without notice. Updated data sheets can be obtained from our website www.bettis.com or from your nearest Valve Automation Center. USA: +1 281 477 4100 Europe: +31 74 256 1010 Asia-Pacific: +65 6501 4600



EMERSON
Process Management

Data sheet

Sheet No.: DPI 5.01 Rev. B
Date: February 2011

D-Series

Construction, Parts and Materials

Standard Actuator

Parts			Materials	
Nr.	Description	Qty.	Description	Notes
1	Body	1	Aluminum Alloy	1
2	Piston	2	Aluminum Alloy	5
3	Drive Shaft	1	Aluminum Alloy	2
4	End Cap DD	2	Aluminum Alloy	-
5	End Cap DS	2	Aluminum Alloy	-
6	Spring- inner	2	Carbon Spring Steel	3
7	Spring- mid	2	Carbon Spring Steel	3
8	Spring- outer	2	Carbon Spring Steel	3
9	Spring Holder	2	Steel	4
10 *	Guide Band, body	1	Nylatron	-
11 *	Guide Band, piston	2	PTFE, Carbon filled	-
12 *	Bearing Bush, shaft bottom	1	Nylatron	-
21 *	O-ring, shaft top	1	Nitrile Rubber	-
22 *	Washer DS, end cap nut	2	Nylon	-
23 *	Washer DD, end cap nut	2	Nylon	-
25 *	O-ring, end cap	2	Nitrile Rubber	-
26 *	O-ring, piston	2	Nitrile Rubber	-
27 *	Washer, shaft top	1	ZEDEX 100 K	-
28 *	O-ring, shaft bottom	1	Nitrile Rubber	-
29 *	O-ring, limit stop bolt, DS	4	Nitrile Rubber	-
30 *	O-ring, limit stop bolt, DD	2	Nitrile Rubber	-
34	Washer DS	2	Steel	4
35 *	Spring Clip	1	Carbon Spring Steel	3
36	End Cap Bolt DD/DS	8	Stainless Steel	-
37	Limit Stop Bolt DS	2	Stainless Steel	-
38	Nut, DS	2	Stainless Steel	-
40	Limit Stop Bolt DD	2	Stainless Steel	-
41	Nut, DD	2	Stainless Steel	-

Parts			Materials	
Nr.	Description	Qty.	Description	Notes
42	Nut Cover	2	Polyethylene	-
43 *	O-ring, B-port	2	Nitrile Rubber	-
44	Insert	1	Aluminum Alloy	1
45	Threaded insert	8	Steel	4
46	Cam for stroke adjustment	1	Stainless Steel	-
47	Shaftpin for stroke adjustment	1	Chrome nickel steel	-
48 *	Washer	1	Nylon	-
49 *	O-ring Front Limit Stop bolt	1	Nitrile Rubber	-
50	Front Limitstop Bolt	1	Stainless Steel	-
51	Nut	1	Stainless Steel	-

* Recommended spare parts (contained in Repair kits)

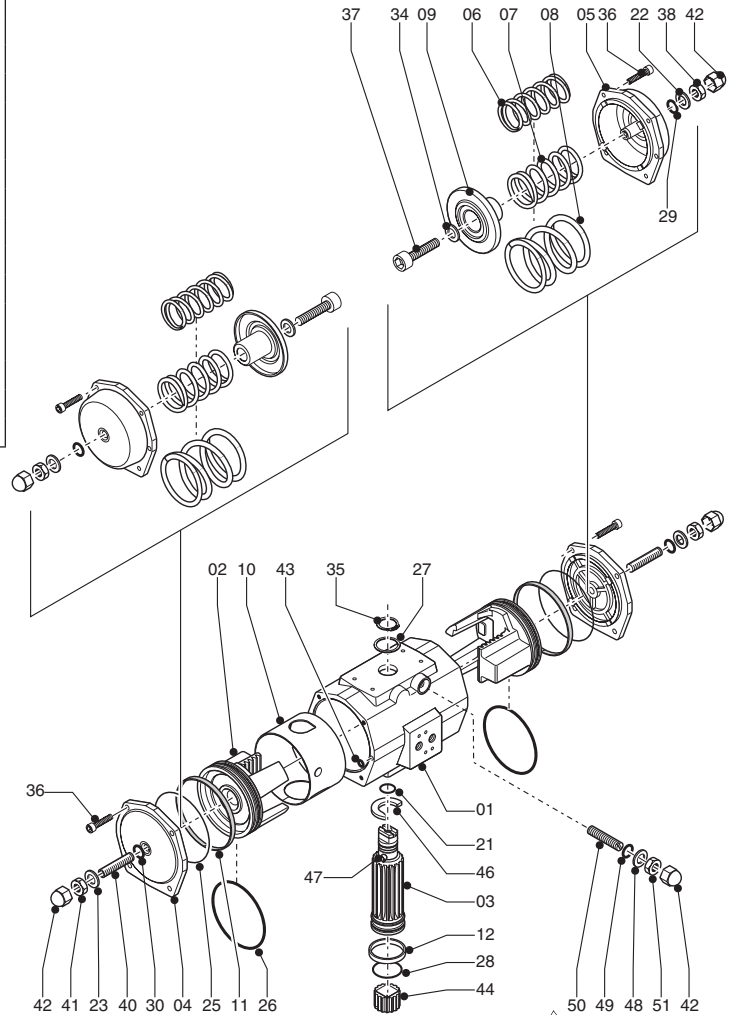

Notes

- 1 Anodized
- 2 "Aircraft grade" aluminum alloy, hard anodized
- 3 Deltatone Coating
- 4 Zinc plated and passivated
- 5 Dichromate treatment

Finish:

Standard : Polyester non-TGIC based powder coating
(see data sheet DPI 6.01)

BETTIS[™]

www.Bettis.com

Copyright © Emerson Process Management. The information in this document is subject to change without notice.
Updated data sheets can be obtained from our website www.bettis.com or from your nearest Valve Automation Center.
USA: +1 281 477 4100 Europe: +31 74 256 1010 Asia-Pacific: +65 6501 4600

EMERSON[™]
Process Management

Data sheet

Sheet No.: DPI 5.02 Rev. A
Date: April 2010

D-Series

Construction, Parts and Materials

Actuators for low temperature applications

Description:

A double piston, rack and pinion pneumatic actuator incorporating a three point piston support system, anti-blowout spindle and with high duty synthetic bearings at all bearing points.

This version is a standard aluminium actuator, but incorporating parts and materials suitable for low temperature operation.

Note:

When operating actuators in sub-zero temperatures (< 0°C or < 32°F) care should be taken to counter the effects of freezing condensate inside the actuator.

Specification:

Max. pressure: 8 bar ~ 120psi
Torque: Standard
Media: Air or non corrosive gas
Temperature: -40°F to +176°F (-40°C to +80°C)
Finish: Polyester non-TGIC based powder coating (see data sheet DPI 6.01).

Spare parts:

Dedicated low temperature spare parts are available for maintenance or make a standard actuator suitable for low temperature operation.

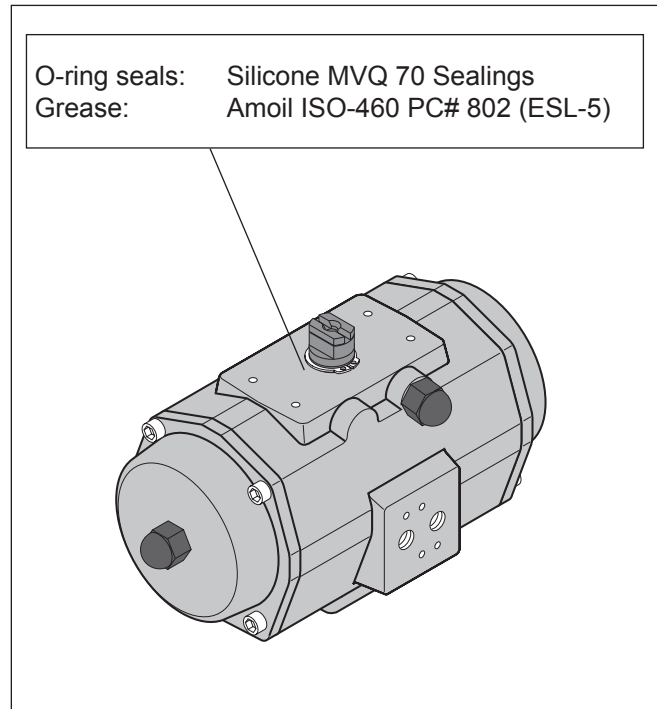

Materials:			
Part	Material	Specifications	Remark
Housing	Aluminium Alloy	UNS A13600, ASTM B85	
Drive Shaft	Aluminium Alloy	UNS 1 77075, ASTM 7075 T6	Hard anodized
Piston	Aluminium Alloy	UNS A03560, ASTM B26	
Sealings	Silicone MVQ 70 O-rings	-/-	
Grease	Amoil ISO-460 PC# 802 (ESL-5)	-/-	
Shaft bearings	Top :	Delrin	POM
	Bottom :	Nylatron	PA6.6 + MoS2
Piston bearings	PTFE	25% Carbon filled	
Bodybearings	Nylatron	PA6.6 + MoS2	
Shaft thrust washer	ZEDEX 100 K	-/-	
End cap bolts	Stainless Steel	AISI 304 A2	
Springs	Carbon Spring Steel	UNS G10860, ASTM A228	Deltatone coating

BETTIS[™]

www.Bettis.com

Copyright © Emerson Process Management. The information in this document is subject to change without notice.
Updated data sheets can be obtained from our website www.bettis.com or from your nearest Valve Automation Center.
USA: +1 281 477 4100 Europe: +31 74 256 1010 Asia-Pacific: +65 6501 4600

EMERSON[™]
Process Management

Data sheet

Sheet No.: DPI 5.03 Rev. A
Date: April 2010

D-Series

Construction, Parts and Materials

Actuators for high temperature applications

Description:

A double piston, rack and pinion pneumatic actuator incorporating a three point piston support system, anti-blowout spindle and with high duty synthetic bearings at all bearing points.

This version is a standard aluminium actuator, but incorporating parts and materials suitable for high temperature operation.

Specification:

Max. pressure : 8 bar ~ 120psi
Torque : Standard
Media : Air or non corrosive gas
Temperature : -4°F to +248°F (-20°C to +120°C)

Spare parts:

Dedicated high temperature spare parts are available for maintenance or make a standard actuator suitable for high temperature operation.

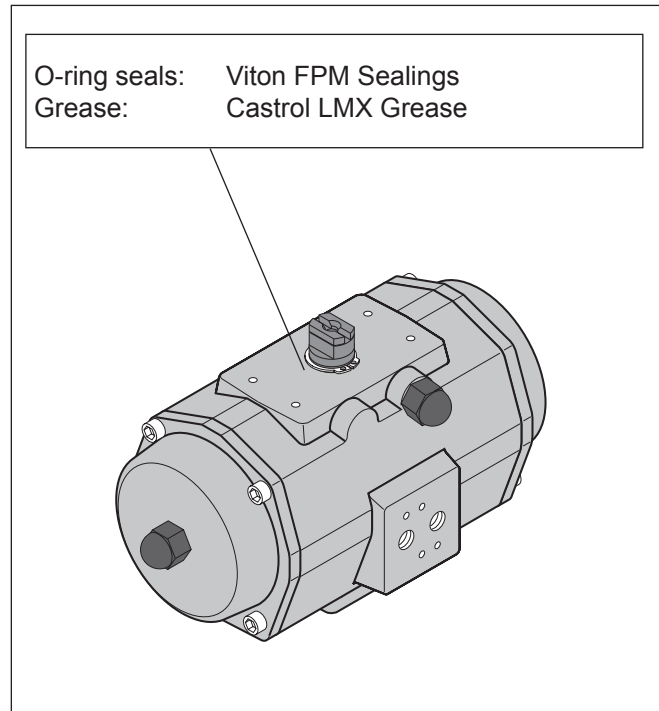

Materials:			
Part	Material	Specifications	Remark
Housing	Aluminium Alloy	UNS A13600, ASTM B85	
Drive Shaft	Aluminium Alloy	UNS 1 77075, ASTM 7075 T6	Hard anodized
Piston	Aluminium Alloy	UNS A03560, ASTM B26	
Sealings	Viton FPM O-rings	-/-	
Grease	Castrol LMX	-/-	
Shaft bearings	Top :	Delrin	POM
	Bottom :	Nylatron	PA6.6 + MoS2
Piston bearings	PTFE	25% Carbon filled	
Bodybearings	Nylatron	PA6.6 + MoS2	
Shaft thrust washer	ZEDEX 100 K	-/-	
End cap bolts	Stainless Steel	AISI 304 A2	
Springs	Carbon Spring Steel	UNS G10860, ASTM A228	Deltatone coating

BETTIS[™]

www.Bettis.com

Copyright © Emerson Process Management. The information in this document is subject to change without notice.
Updated data sheets can be obtained from our website www.bettis.com or from your nearest Valve Automation Center.
USA: +1 281 477 4100 Europe: +31 74 256 1010 Asia-Pacific: +65 6501 4600

EMERSON[™]
Process Management

Data sheet

Sheet No.: DPI 6.01 Rev. A
Date: April 2010

D-Series

Bettis D-Series corrosion protection system

Description:

The corrosion protection system of the standard Bettis D-Series pneumatic actuators consist of the following treatments or materials:

1 De-greasing.

All aluminum parts are de-greased before the powder coating is applied by washing with an alkaline solution to assure the best bonding between the aluminum surface and the coating.

2 Powder coating.

- Polyester non-TGIC based powder coating for exterior use.
- The powder coating is applied cold using automatic electrostatic spray equipment and is cured at minimum 190°C (374°F) offering excellent light and weather resistance.
- The powder coating thickness is 1.5 mils (37 microns) minimum, and 2 mils (50 microns) average.
- Good chemical resistance against most bases, acids, solvents, alkalis and oils at normal temperatures.
- Excellent exterior mechanical durability.
- The coating has passed a salt spray test according to ASTM B117 for 500 hours. The powder coating is virtually solvent free, and therefore environmentally friendly.

3 High grade & anodized aluminum pinion.

Actuators with high grade & anodized aluminum pinions, passed a 500 hours salt spray test. Optional stainless steel pinions are available with a higher corrosion resistance.

4 Stainless steel or Deltatone treated external steel parts.

External parts are stainless steel or steel alloy with a Deltatone® treatment.

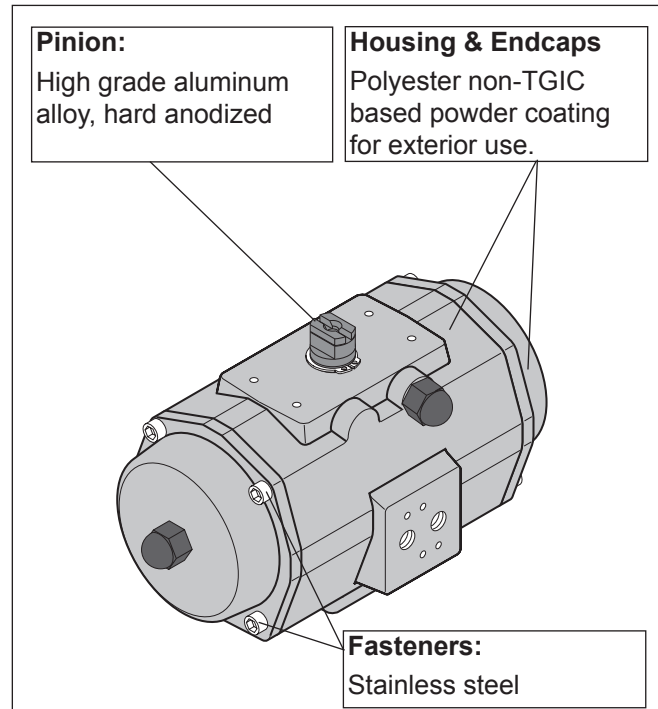
**Pinion:**

High grade aluminum alloy, hard anodized

Housing & Endcaps

Polyester non-TGIC based powder coating for exterior use.

Fasteners:

Stainless steel

Technical data:

Coating	: Polyester non-TGIC based powder coating
Salt spray test	: DIN 50021 / ASTM B117: 500h.
Max. temperature	: -4°F to 176°F (-20° to + 80°C)
Color	: Bettis orange
Materials	: Housing : Aluminium alloy : Pinion : High grade aluminum alloy : Fasteners: Stainless steel or alloy steel with Deltatone treatment : Tagplate : Stainless steel
Application	: Standard Bettis D-Series pneumatic actuators.

BETTIS™

www.Bettis.com

Copyright © Emerson Process Management. The information in this document is subject to change without notice.
Updated data sheets can be obtained from our website www.bettis.com or from your nearest Valve Automation Center.
USA: +1 281 477 4100 Europe: +31 74 256 1010 Asia-Pacific: +65 6501 4600

EMERSON™
Process Management

Data sheet

Sheet No.: DPI 7.01 Rev. A
Date: April 2010

D-Series

Assembly modes

DD - Double acting actuator

1 = A-port pressurized
2 = B-port pressurized

All views are from above
Pistons are shown in inner position

Rotate complete standard Mode A actuator 90° and rotate the visual indicator back 90°.

STANDARD MOUNTING IN LINE	A	B	MOUNTING ACROSS LINE
MOUNTING ACROSS LINE	C	D	MOUNTING IN LINE

Important:
When a standard "Mode-A" actuator is re-assembled to "Mode D", the end cap and front stop-screws will adjust the closed position. There is no adjustment for the open position!

Rotate complete Mode "D" actuator 90° and rotate the visual indicator back 90°.

Pistons turned 180° (from standard)

Factory option: Mode "D" Pinion Factory option: Mode "D" Housing



Data sheet

Sheet No.: DPI 7.02 Rev. A
Date: April 2010

D-Series

Assembly modes

DS - Single acting (Spring Return) actuator

1 = A-port pressurized
2 = Spring stroke

All views are from above
Pistons are shown in inner position

Rotate complete standard Mode A actuator 90° and rotate the visual indicator back 90°.

Spring-to-Close (ROTATION CW)			
STANDARD MOUNTING IN LINE	A	B	MOUNTING ACROSS LINE
MOUNTING ACROSS LINE	C	D	MOUNTING IN LINE
Spring-to-Open (ROTATION CCW)			

Rotate complete Mode "D" actuator 90° and rotate the visual indicator back 90°.

Pistons turned 180° (from standard)

Factory option: Mode "D" Pinion **Factory option: Mode "D" Housing**

Important:
When a standard "Mode-A" actuator is re-assembled to "Mode D", the end cap and front stop-screws will adjust the closed position. There is no adjustment for the open position!

Data sheet

Sheet No.: DPI 8.01 Rev. A
Date: April 2010

D-Series

Springset configuration

DS - Single acting (Spring Return) actuator

Springsets

Bettis DS Single acting (Spring Return) actuators have up to 3 different concentric springs on each side of the actuator.

This allows up to 6 ballanced spring configurations as shown below.

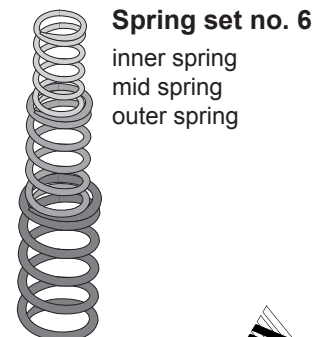
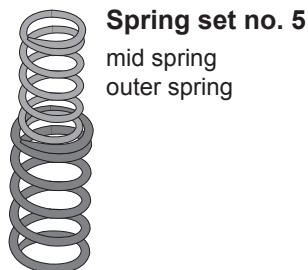
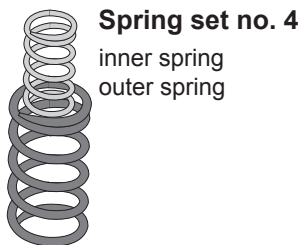
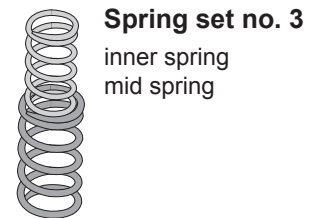
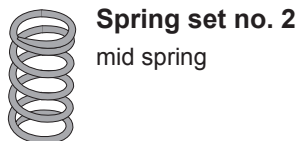
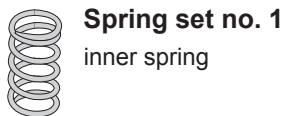
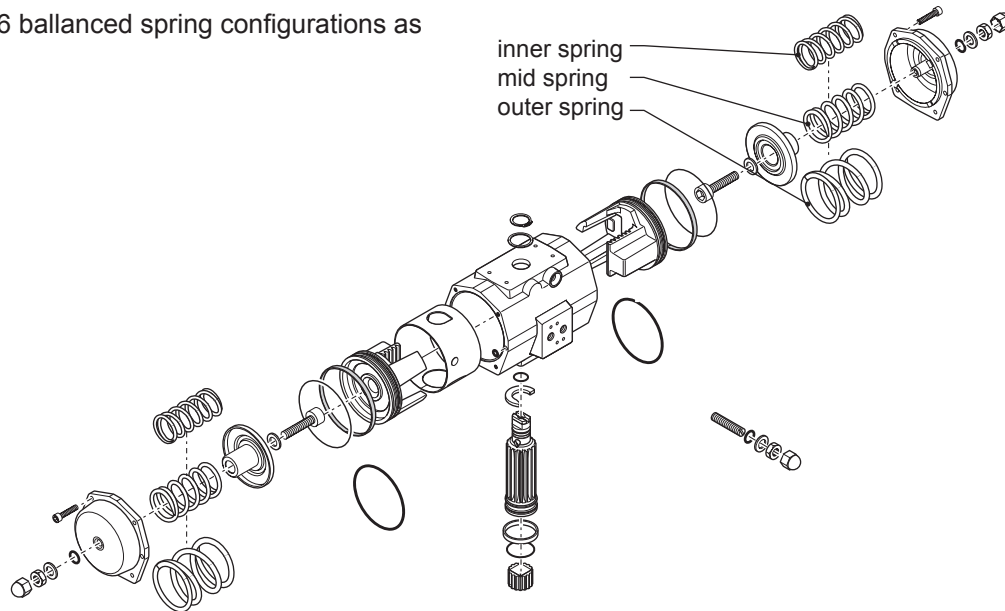

BETTIS[™]

www.Bettis.com

Copyright © Emerson Process Management. The information in this document is subject to change without notice.
Updated data sheets can be obtained from our website www.bettis.com or from your nearest Valve Automation Center.
USA: +1 281 477 4100 Europe: +31 74 256 1010 Asia-Pacific: +65 6501 4600

EMERSON[™]
Process Management

Data sheet

Sheet No.:
Date:

D-Series

BETTIS™

www.Bettis.com

Copyright © Emerson Process Management. The information in this document is subject to change without notice.
Updated data sheets can be obtained from our website www.bettis.com or from your nearest Valve Automation Center.
USA: +1 281 477 4100 **Europe:** +31 74 256 1010 **Asia-Pacific:** +65 6501 4600

EMERSON™
Process Management

Data sheet

Sheet No.:
Date:

D-Series

BETTIS™

www.Bettis.com

Copyright © Emerson Process Management. The information in this document is subject to change without notice.
Updated data sheets can be obtained from our website www.bettis.com or from your nearest Valve Automation Center.
USA: +1 281 477 4100 **Europe:** +31 74 256 1010 **Asia-Pacific:** +65 6501 4600

EMERSON™
Process Management

Data sheet

Sheet No.:

Date:

D-Series

BETTIS[™]

www.Bettis.com

Copyright © Emerson Process Management. The information in this document is subject to change without notice.
Updated data sheets can be obtained from our website www.bettis.com or from your nearest Valve Automation Center.
USA: +1 281 477 4100 **Europe:** +31 74 256 1010 **Asia-Pacific:** +65 6501 4600

EMERSON[™]
Process Management

Contact Us: Emerson Process Management, Valve Automation facilities at your nearest location:

NORTH & SOUTH AMERICA

19200 Northwest Freeway
Houston, TX 77065
USA
T +1 281 477 4100
F +1 281 477 2809

2500 Park Avenue West
Mansfield, OH 44906
USA
T +1 419 529 4311
F +1 419 529 3688

13840 Pike Road
Missouri City, Texas 77489
USA
T +1 281 499 1561
F +1 281 499 8445

Av. Hollingsworth,
325, Iporanga Sorocaba,
SP 18087-105
Brazil
T +55 15 3238 3788
F +55 15 3228 3300

MIDDLE EAST & AFRICA

P. O. Box 17033
Dubai
United Arab Emirates
T +971 4 811 8100
F +971 4 886 5465

P. O. Box 105958
Abu Dhabi
United Arab Emirates
T +971 2 697 2000
F +971 2 555 0364

P. O. Box 3911
Al Khobar 31952
Saudi Arabia
T +966 3 814 7560
F +966 3 814 7570

P. O. Box 10305
Jubail 31961
Saudi Arabia
T +966 3 340 8650
F +966 3 340 8790

P. O. Box 32281
Doha
Qatar
T +974 4 576777
F +974 4 315448

24 Angus Crescent
Longmeadow Business Estate
East P.O. Box 6908; Greenstone;
1616 Modderfontein, Extension 5
South Africa
T +27 11 451 3700
F +27 11 451 3800

EUROPE

Asveldweg 11
7556 BR Hengelo (O)
The Netherlands
T +31 74 256 1010
F +31 74 291 0938

Siemensring 112
47877 Willich
Germany
T +49 2154 499 660
F +49 2154 499 6613

25, Rue de Villeneuve
Silic – BP 40434
94583 Rungis
France
T +33 1 49 79 73 00
F +33 1 49 79 73 99

Via Montello 71/73
20038 Seregno (Milan)
Italy
T +39 0362 2285 207
F +39 0362 2436 55

6 Bracken Hill
South West Industrial Estate
Peterlee SR8 2LS
United Kingdom
T +44 191 518 0020
F +44 191 518 0032

2A Szturmowa Str
02-678 Warsaw
Poland
T +48 22 45 89 237
F +48 22 45 89 231

C/ Francisco Gervás, 1
28108 Alcobendas – Madrid
Spain
T +34 0913 586 000
F +34 0913 589 145

Letnikovskaya Str. 10-2
115114 Moscow
Russia and FSU
T +7 495 981 98 11
F +7 495 981 98 10

ASIA PACIFIC

No. 9 Gul Road
#01-02 Singapore 629361
T +65 6501 4600
F +65 6268 0028

9/F Gateway Building
No. 10 Ya Bao Road
Chaoyang District
Beijing 100020
P.R.China
T +86 10 5821 1188
F +86 10 5821 1100

No.1 Lai Yuan Road
Wuqing Development Area
Tianjin 301700
P.R.China
T +86 22 8212 3300
F +86 22 8212 3308

Lot 13112, Mukim Labu
Kawasan Perindustrian Nilai
71807 Nilai, Negeri Sembilan
Malaysia
T +60 6 799 2323
F +60 6 799 9942

471 Mountain Highway
Bayswater, Victoria 3153
Australia
T +61 3 9721 0200
F +61 3 9720 0588

Delphi B Wing, 601 & 602
6th Floor, Central Avenue
Powai, Mumbai – 400 076
India
T +91 22 6662 0566
F +91 22 6662 0500

All rights reserved.

No part of this publication may be copied or published by means of printing, photocopying, microfilm or otherwise without prior written consent of Emerson Process Management. This restriction also applies to the corresponding drawings and diagrams.

Emerson Process Management has the right to change parts of the machine at any time without prior or direct notice to the client. The contents of this publication are subject to change without notice.

This publication is to be used for the standard version of the machine only. Thus Emerson Process Management cannot be held responsible for any damage resulting from the application of this publication to the version actually delivered to you.

For extra information as to adjustments, maintenance and repair, contact the technical department of your supplier.

This publication has been written with great care. However, Emerson Process Management cannot be held responsible, either for any errors occurring in this publication or for their consequences.

©2013 Emerson Electric Co.

BETTIS™

www.Bettis.com



EMERSON™
Process Management